

Typical centre opening overlap tab track arrangement

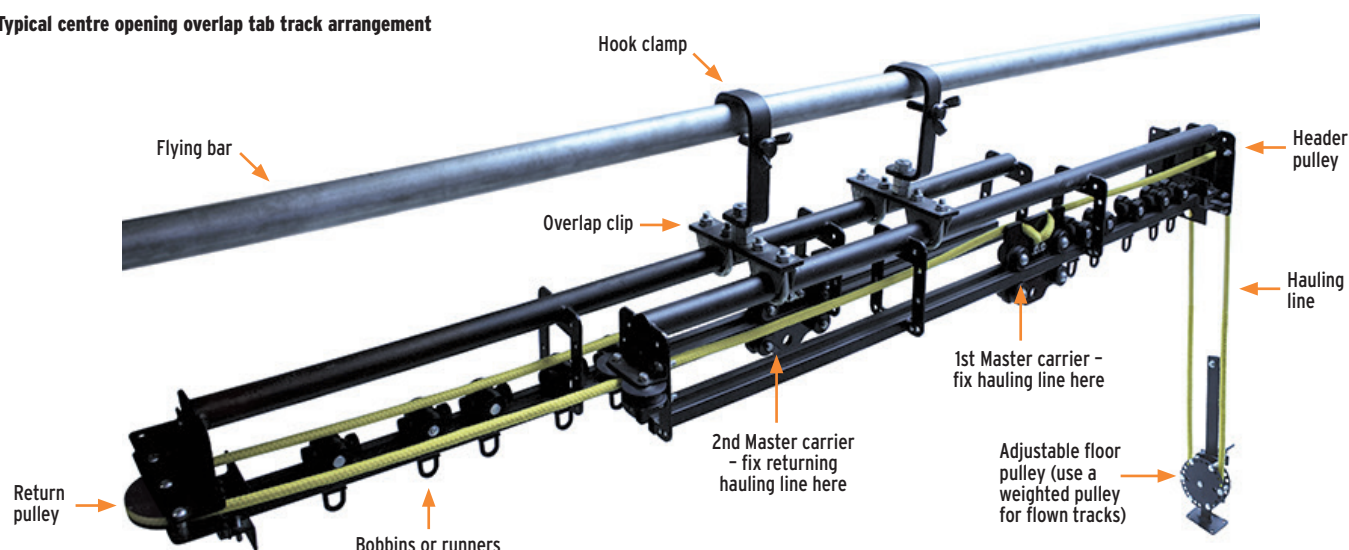

Tab Track Terminology

At first glance a tab track may appear complicated but all the components from each manufacturer have basically the same functions. We have described them below to help you choose but, if you prefer, just phone us and we will calculate all your component needs.

Bobbins or Runners: These run along the track, normally on small wheels, and carry the drapes. Generally, they are spaced at around 250 – 300 mm apart.

Rearfold Runners: Runners with an attachment that grips the control line [until offstage] to enable a cloth to move off stage without gathering from the leading edge. Only normally used with painted cloths.

Master Runners: The master runner is the lead runner. It will normally have a clamping plate to grip the control cord. For a centre opening track you will need two master runners. Clamp the handline to one runner, then thread it around the return pulley at the end of the track and clamp the returning part of the cord to the other master runner. Even if the drapes are just to be pulled along it is wise to have a master runner at the leading edges as this runner will take a greater strain than ordinary bobbins. Alternatively, mount two ordinary bobbins close together to share the strain.

Overlap Arms: Some master runners will take an overlap arm which allows centre opening drapes to overlap. The alternative is to overlap the tracks but to do this you will need overlap clips plus offset plates to ensure the hook clamps align with the flying bar.

Header Pulley: This double sheave vertically aligns pulley bolts to the operator end of the track. Sometimes two designs are available, one for overlap tracks and one for single tracks.

Return Pulley: Horizontal pulley bolted to the far end of the track.

Floor Pulley: These pulleys are fixed to the floor and the sheave can be adjusted to put tension in the cord. If your track needs to fly out then choose a foot-stirrup pulley or a weighted pulley. If you choose a weighted pulley ensure that you use a polyester handline and that regular checks are made to guard against chafe.

Handline: Tracks take 6 or 8 mm diameter handlines. Nowadays most people choose matt black polyester line rather than jute sash. If you are using a weighted pulley do not use jute sash. For the track to operate the line needs to be tied [or clamped] to form a loop. The best place to do this is just behind a master carrier rope clamp as this position never has to pass through a pulley.

How to Cord Up a Tab Track

Position the assembled track at a comfortable working height. The cording principle is based on a long loop of cord, the loop being formed by clamping both the ends onto the "Cord End Master Carrier". If the track is "centre opening" then the other "slave" master carrier will be clamped to the returning cord. To cord a typical centre opening track, position the master carriers in the "Tabs Closed" position [centre stage]. Loosely tie or clamp one end of the cord onto the "Cord End Master Carrier" and thread the cord around the horizontal return pulley then back along the track passing through the rope clamp on the "slave master carrier". Loosely tighten the clamp plate and continue with the cord to the header pulley. Take it over the header pulley, around the foot-stirrup or floor-mounted pulley and back over the other sheave on the header pulley and finally back to the "Cord End Master Carrier". Ensure you have the correct drop for the floor mounted pulley and then loosely clamp the rope in place. Don't chop off the excess just yet! Take the track to its operational position. Try the track to ensure it is corded correctly then tighten the rope clamps and cut off the excess cord.

[Based loosely on an extract from the Unitrack Manual].

Sound Advice

Modern steel scenery clad in 4 mm ply can act as a sounding board and may amplify any track noise if the track is directly attached to the steel. "L" shaped corners in scenery such as pelmets or soffits also have an amplifying effect and should be avoided if possible.

Shipping

We used to have problems shipping lengths between 3 and 6m long, however these are now largely resolved, but it's worth noting a 3 m length has the benefit of being able to fit into most Transit-sized vans. We carry 2 m lengths as standard in our hire stock which can be joined using Joint Sets. For full details of our delivery services see back of catalogue.

Not sure what track system you have?

Flints has a wide experience of tab tracks based on forty-years of theatre work. We can normally recognise a component from a digital photo or sketch. Even very old components can often be supplied.

If you have a troublesome track we can provide remote assistance, or if required we can visit your stage to either effect immediate repairs, or suggest a course of action. Below we have listed some of the common components and spares that we can supply.

MEDIUM-DUTY TRACKS

Triple E 2-Way Track

This well proven track from Triple E is designed for lightweight curtains and can be used instead of domestic tracking to provide the reliable service expected from Triple E products. The track is available in lengths up to 6.1 m [20ft] and can be provided prerolled for curved installations. 2Way has a continuous suspension slot along the top to take Triple E fittings, or it can be screwed directly to a soffit by using ceiling clips.

The track is quickly joined with a steel plate and grub screws locating in the top slot while two roll pins provide alignment of the running surfaces, see left. The runners are designed to take ties or twin hooks but steel wire hooks are also available for use with Rufflette tapes. This track is not available as a corded version.

- ✓ Smart good looks - can be custom powder coated on request.
- ✓ Ideal for pubs, clubs and small performance venues
- ✓ Good choice for cycloramas in small photographic, TV and drama studios, and exhibition or office environments.

✓ Use it for "on scenery" drapes

✓ Can take up to 88 kg Uniform Distributed Loads at 1 m centres

✗ Not available corded

✗ Not suitable for touring

Triple E Ltd

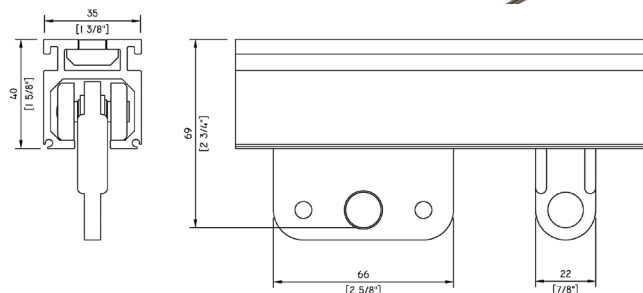
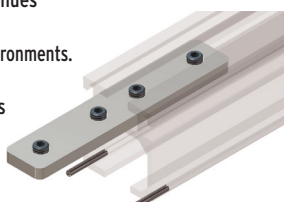

code	description	price
EEE2W01B	Straight Track up to 6 m long black [per m]	£28.00
EEE2W01S	Straight Track up to 6 m long silver [per m]	£19.00
EEE2W01BC75090	Curved Track 90° section 750 mm radius black	£84.70
EEE2W01SC75090	Curved Track 90° section 750 mm radius silver	£63.10
EEE2W01BC100090	Curved Track 90° section 1 m radius black	£95.90
EEE2W01SC100090	Curved Track 90° section 1 m radius silver	£70.70
EEE2W01BC	Curved Track special to order black [per m]	£41.00
EEE2W01SC	Curved Track special to order silver [per m]	£32.00
EEE2W05	Joint Plate with two pins	£12.25
EEE2W24	Endstop [black]	£8.00

2-Way Runners

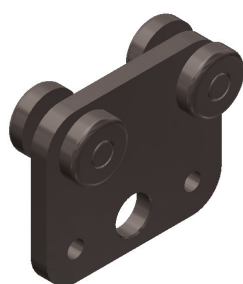

Master Runner



Standard Runner

code	description	price
EEE2W06P	Plain Wheel Runner	£4.00
EEE2W06C	Ball Raced Wheel Runner	£7.00
EEE2W07W	Master Runner [WLL 30 kg no cord clamp]	£13.00
EEE2W29	Wire S-Hooks [for use with Rufflette tapes]	£1.20

2-Way Mounting



code	description	price
EEEM8ERAILNUT	M8 Attachment Nut	£1.35
EEEERL1402	Hook Clamp for 50 mm tube/truss	£20.00
EEE2W30	Ceiling Mount Clamps [5 pairs]	£14.00
EEETRA1601 NEW	Wall Bracket 300 mm	£45.00
EEETRA1602 NEW	Wall Bracket 500 mm	£62.00
EEEEERL18	Studding set [M8x150 direct to track]	£5.00

Halls T60 Anglia Track

Designed to meet the requirements of most small- and medium-sized stages and television and video facilities with cycloramas. Curtains can be hand-pulled, electrically or hand-winch or just walked along. The maximum recommended length for a single wipe track is 9 m or 18 m for an overlapped track. Single tracks can be easily suspended from bars by using the T60 universal fittings bolted to Hook Clamps [page 373]. Overlap tracks should use the "Z" brackets, see left, to centre the track on the bar. The tracks can be supplied in 45° and 90° curved sections. If you need to cut down a track onsite to fit to an exact dimension then purchase a Modular Track Clip, see left, to reinstate the end plate after cutting. Please phone for a complete list of components and prices.

✓ Often installed in school stages

✓ Old design, so tried and tested

✗ Slightly fiddly joint bolts

✗ Old design may not suit modern stages

Hall Stage

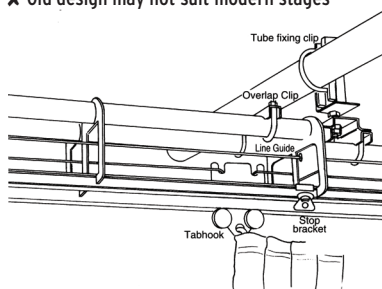

code	description	price
HALT60576	Straight Track 500 mm section	£35.96
HALT60580	Straight Track 1 m section	£47.20
HALT60584	Straight Track 2 m section	£78.62
HALT60586	Straight Track 3 m section [max] [other lengths and curved sections available, please phone for details]	£104.60
HALT610931	Modular Track Clip	£45.08
HALT63756	Joint Bolts [per 10] [2 shouldered + 2 hex sets: nuts, washers – enough for one joint.]	£19.31
HALT65730	Endstops [per 2]	£16.90

Halls T60 Anglia Runners



code	description	price
HALT63750	Master Carrier [per 2]	£45.29
HALT64348	Master Carrier ball raced for scenery flat	£127.02
HALT60517	Master Carrier ball raced for swivel arm	£107.88
HALT62132	Wheeled Runner [per 10] [SWL 4 kg. Space 300 mm]	£31.68
HALT60542	Ball Raced Runner [per 10]	£57.64
HAL3578	Tab Hook [per 10]	£10.96
HAL1701E	Twin Hooks [each]	£1.02

Halls T60 Anglia Pulleys

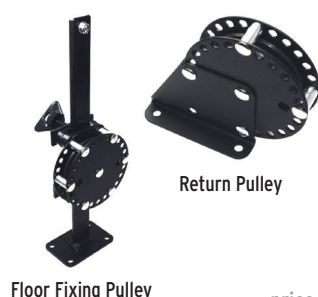

code	description	price
HALT61188	Head Pulley [handline]	£45.54
HALT61187	Return Pulley [handline]	£30.05
HALT61182	Floor Fixing Pulley [handline]	£62.17
HALT63758	Weighted floor pulley	£54.05

Halls T60 Anglia Mounting



code	description	price	
HALT63291	Overlap Clip [per 2]	£20.04	
HALT63753	T60 Universal Fitting [per 2]	£22.25	
HALT63136	Stud Hanger to 48 mm Ø [per 2]	£38.11	
HALT610965	"Z" Tube 48 mm to overlap track [per pair]	£30.34	
HALT61181	Face Fixing Bracket [per pair]	£31.13	
HALT60963	Deadline Suspension fitting [per 2]	£21.80	
code	description	per m	10+ reels
ROP120	Black 6 mm x 8 plait polyester handline [per m]	£1.14	£72.08

Erail

A significantly improved version of the previous Unirail system. The track is a tough one-piece black aluminium extrusion available in lengths up to 6.1 m [20 ft]. Joins are made with a steel plate and grub screw in the top slot with a single roll pin in the base to ensure smooth running surfaces. The track can be rolled down to a 500 mm radius. Erail can be mounted by means of special M8 channel nuts in the top slot allowing easy connection to a hook clamp or M8 studding. Low friction ball-raced nylon runners ensure easy handling of the drapes. Centre opening drapes can be overlapped either by using overlap arms on the master carriers, or the pre-assembled centre opening unit. The track can also be corded for manual use or motorised by using the track mounted S-Drive [supplied with 10 m pendant].

✓ Ideal for small stages such as on cruise ships, conference centres, hotels and school halls ✓ Can be ordered to special radii with fast delivery times ✓ Sleek modern appearance ✓ Lower profile than most tracks ✓ Economically priced ✓ Can take up to 70 kg Uniformly Distributed Loads at 1 m centres 8 Suitable for all but the very heaviest of stage curtains ✗ No scenery carriers or rearfold runners available ✗ Care should be taken when touring to protect long lengths from bending and edge damage.



Erail Track

code	description	price
EEEEERL01	Straight Track [up to 6.1 m sold per m]	£28.50
EEEEERL01C	Curved Track [up to 6.1 m sold per m]	£41.50
EEEEERL05	Joint Plate complete with Roll Pin	£17.75
EEEEERL24	Endstop	£16.00
EEEEERL26C	Pre-assembled centre opening unit [3 m]	£158.50

Erail Runners

code	description	price
EEEEERL06	2 Wheeled Runner	£9.50
EEEEERL07S12	12 Wheel Master Runner with Rope Clamp [WLL 30 kg]	£102.00
EEEEERL07A12	Overlap Arm	£17.50

Erail Pulleys

code	description	price
EEEEERL09	Head Pulley	£80.00
EEEEERL10	Return Pulley	£55.00

Erail Mounting and Accessories

code	description	price
EEEEERL19	Curved Cord Guide	£30.00
EEEEERL21	Head Pulley Cord Guide	£32.00
EEEEERL1402	Hook Clamp for 50 mm tube/truss	£20.00
EEETRA15	Deadline Fixing	£10.00
EEEEERL17	Mounting Bracket	£10.00
EEEM8ERAILNUT	M8 Attachment Nut	£1.35
EEEEERL18	Studding set [M8x150 direct to track]	£5.00
EEEEERL23	Curved Track Suspension Bracket	£18.50
EEEEERL25	Line Pick Up	£9.50
EEEEERL26	Overlap Clip	£14.15

code	description	per m	10+ reels
ROP122A	8 mm x 8 plait black rope	£1.40	£94.81
EEESDRIVE	SDrive [motorised control system w/ 10 m pendant]		£1,555.00

code	description	price
TRAWC	Wireless Controller	£500.00

Doughty Six Track

This track was designed as competition to the Halls T60 track. They are remarkably similar. The Doughty barrel brackets are nicely designed to allow overlap tracks to hang centrally on the flying bar. They also came up with a bolt-on end plate [above] enabling the track to be cut to exact lengths without the need for onsite welding but Halls responded and now make one of these as well. Oh, the joys of competition!

- ✓ Ideal for schools and colleges
- ✓ Economically priced
- ✓ Versatile modular system
- ✗ A bit fiddly for tours.

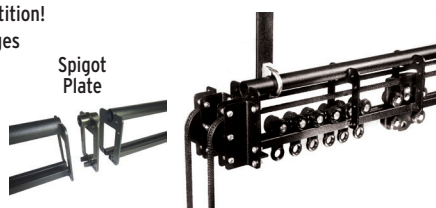

Doughty Six Track

code	description	price
DOUT63706	Straight Track 500 mm section	£37.28
DOUT63708	Straight Track 1 m section	£55.57
DOUT63710	Straight Track 2 m section	£93.15
DOUT63715	Straight Track 3 m section [max]	£132.48
DOUT63730	Curved Track 90° 500 mm radius	£107.63
DOUT63731	Curved Track 90° 750 mm radius	£124.20
DOUT63732	Curved Track 90° 1 m radius	£149.70
DOUT63748	Six Track Spigot plate	£3.76
DOUT63765	Bolt-on End Plate [if cutting track]	£17.60
DOUT63760	Endstop [for walk along system]	£9.30



Endstop



Runners - plain or ball raced



Master Runner

Doughty Six Track Runners

code	description	price
DOUT63756	Ball Raced Runner WLL 6 kg [use every 300 ,mm]	£7.11
DOUT63757	Plain Bearing Runner WLL 6 kg [use every 300 mm]	£4.05
DOUT63755	Master Runner	£29.58



Twin-Head Pulley



Return Pulley



Weighted Pulley



Floor Fixing Pulley



Overlap Bracket



Barrel Bracket for Overlap Track



Adjustable Support Bracket



Short Support Bracket

Doughty Six Track Pulleys and Accessories

code	description	price
DOUT63776	Twin-head Pulley	£55.87
DOUT63775	Return Pulley	£34.14
DOUT63820	Weighted Handline Pulley	£55.43
DOUT63825	Floor Fixing Handline Pulley	£73.71
DOUT63752	Overlap Bracket	£10.14
DOUT63770	Line Support [every 2.5 m]	£43.47
DOUT63753	Barrel Bracket for overlap track	£18.15
DOUT63750	Adjustable Support Bracket [takes 10 mm studding]	£9.30
DOUT63751	Short Support Bracket	£8.80
ROP22A	8 mm x 8 plait black rope	£1.40
DOUT63795	Fixing Kit for Six Track [100 bolts nut and washers]	£13.87

Studio Rail Track

A light and extremely strong track system with several unique features. A pair of four-wheel double swivel carriages [above] allows an adjustable moving rail to be mounted to a pair of fixed parallel rails. The six-wheel carriage with a 28 mm receiver [left] has a SWL of a massive 100 kg. Fitted with a friction brake it stays where it's put. Use it for luminaires, monitors and pantographs etc. It has three points of safety: a 6 mm Ø pin, a sword pin, and finally, the lamp can be rotated then locked in place with a Doughty knob. The cupped curtain brake [above] moves by means of an operator's pole, then twists to engage the brake. We stock the extrusions in natural aluminium but anodised black is also available.

- ✓ Versatile – used in theatres, schools, studios, nightclubs
- ✓ Takes luminaires, monitors, and pantographs

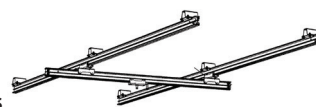

Studio Rail Track

code	description	price
DOUT84000	Straight Track 2 m silver	£85.30
DOUT84005	Straight Track 3 m silver	£125.41
DOUT84010	Straight Track 4 m silver	£170.28
DOUT84015	Straight Track 6 m silver	£253.42
DOUT84070	Joiner Kit	£17.09
DOUT84080	Endstops [four]	£14.32

Studio Rail Curved Track

code	description	price
DOUT84017	Curved Track 90° section 750 mm radius silver	£139.17
DOUT84018	Curved Track 90° section 900 mm radius silver	£168.38
DOUT84019	Curved Track 90° section 1,050 mm radius silver	£197.58
DOUT84020	Curved Track 90° section 1,200 mm radius silver	£211.32
DOUT84025	Curved Track 90° section 1,350 mm radius silver	£213.03
DOUT84030	Curved Track 90° section 1,500 mm radius silver	£219.06

Studio Rail Runners & Carriages



Cable Carriage



Rearfold Runner



Overlap Arm



Wall Brackets



Operator's Pole

code	description	price
DOUT84220	Cable Carriage [five]	£58.57
DOUT84225	Curtain Carriage [five]	£46.57
DOUT84205	6-Wheel Carriage + 28 mm TV Spigot Receiver	£129.72
DOUT84185	4-Wheel Carriage + 16 mm Spigot	£52.82
DOUT84516	6-Wheel Carriage with Swivel	£200.73
DOUT84215	Double Swivel Carriage	£94.82
DOUT84230	Cupped Curtain Brake	£63.62
DOUT84249	Operator's Pole 3.7 m open / 2 m closed	£194.92
DOUT84120	Ceiling Bracket	£27.41
DOUT84105	Wall Bracket 200 mm	£31.78
DOUT84106	Wall Bracket 350 mm	£36.96
DOUT84107	Wall Bracket 500 mm	£42.08
DOUT84180	Rail to Tube Bracket Fitting	£52.41

HEAVY-DUTY TRACKS

Triple E UniTrack

Our biggest selling track and the track that we choose for our own hire stock. UniTrack is a versatile modular track system, used widely for theatres, exhibitions, trade shows and rock and roll tours. Sections are available in standard lengths of 2 m, 1 m, 500 mm and 250 mm. The design is such that the track sections stack neatly on trucks or in storage making this system the preferred choice for tours. Special curved sections are available to order and there are at least 16 ways of cording the track, with the option to add drive motors. A range of suspension fittings is available. Runners should generally be spaced at 300 mm intervals. Standard and curved runners have Working Load Limit of 25 kg, whilst master runners and scenery carriers have a WLL of 50 kg. Heavy-duty Carriers have a WLL of 125 kg.

- ✓ Industry favourite ✓ Well proven
- ✓ Stacks very neatly for storage ✓ Ideal for touring
- ✓ Just one bolt to join lengths ✓ Motorised versions available
- ✓ Takes scenery carriers including heavy-duty versions
- ✓ Huge range of roping methods including rearfold
- ✓ Extra parts may be hired for the occasional show requiring many tracks. [page 404]
- ✓ Can take up to 400 kg Uniformly Distributed Loads at 1 m centres
- ✗ Takes up quite a lot of height so not ideal for height-restricted venues

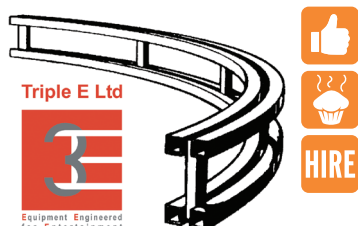

UniTrack Standard Track



code	description	price
EEETRA01	Straight Track 250 mm	£40.00
EEETRA02	Straight Track 500 mm	£47.00
EEETRA03	Straight Track 1 m	£77.00
EEETRA04	Straight Track 2 m	£100.00
EEETRA05	Joint Set	£6.00

UniTrack Curved Track

code	description	price
EEETRA1090	Curved Track 90° section 1 m radius	£222.50
EEETRA1590	Curved Track 90° section 1.5 m radius	£300.00
EEETRA2090	Curved Track 90° section 2 m radius	£360.00
EEETRA3090	Curved Track 90° section 3 m radius	£540.00

UniTrack Runners



Standard Raced Runner

Rearfold Runner

Overlap Arm

code	description	price
EEETRA06	Standard Raced Runner, 2 wheels	£17.50
EEETRA06C	Raced Runner for curves, 4 wheels	£24.00
EEETRA06R	Rearfold Runner	£24.00
EEETRA07	Master Runner	£77.00
EEETRA07A	Master runner overlap arm	£16.50
EEETRA08	Rearfold Accessory	£7.00

UniTrack Carriers

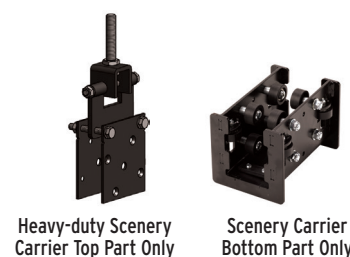

Heavy-duty Scenery Carrier Top Part Only

Scenery Carrier Bottom Part Only

code	description	price
EEETRA28A	Scenery Carrier top only [WLL 50 kg]	£77.00
EEETRA28B	Scenery Carrier bottom only	£65.50
EEETRA28AHD	Scenery Carrier heavy-duty top only [WLL 125 kg]	£220.00

UniTrack Pulleys

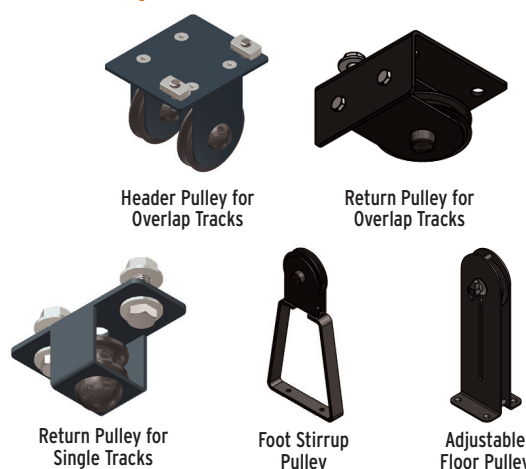

Header Pulley for Overlap Tracks

Return Pulley for Overlap Tracks

Return Pulley for Single Tracks

Foot Stirrup Pulley

Adjustable Floor Pulley

code	description	price
EEETRA09	Head Pulley	£82.50
EEETRA10	Return Pulley	£50.00
EEETRA0902 NEW	Head Pulley HD - Single Track	£87.00
EEETRA31R	Single Track Return Pulley	£29.19
EEETRA11	Foot Stirrup	£57.00
EEETRA12	Adjustable Floor Pulley	£57.00

UniTrack Suspension Fittings

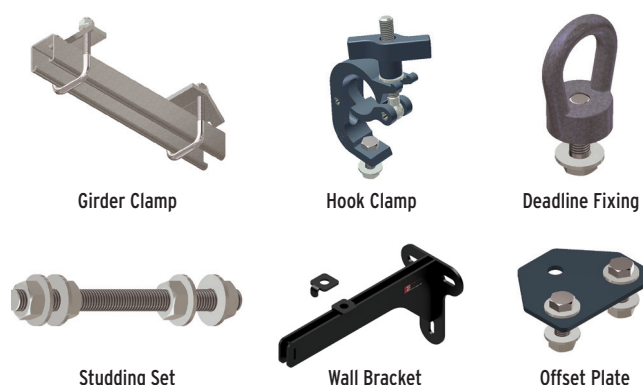

Girder Clamp

Hook Clamp

Deadline Fixing



Studding Set

Wall Bracket



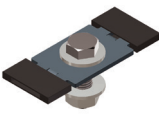

Offset Plate

code	description	price
EEETRA13	Girder Clamp	£20.00
EEETRA14	Fitted with M12 x 50 mm bolt	£40.00
EEETRA15	Deadline Fixing	£10.00
EEETRA1601 NEW	Wall Bracket 300 mm	£45.00
EEETRA1602 NEW	Wall Bracket 500 mm	£62.00
EEETRA17	Offset Plate	£8.00
EEETRA18	Studding Set [M12 x 150 mm]	£6.00



UniTrack Components

			
Endstop	Flat Endstop	Line Pick Up	Overlap Clip Set
code	description	price	
EEETRA24	Endstop	£12.00	
EEETRA24S	Flat Endstop	£20.00	
EEETRA25	Line Pick Up	£10.00	
EEETRA26	Overlap Clip	£15.00	

UniTrack Curved Track Fittings

			
Curve Cord Guide	Curve Master Runner	Curve Head Pulley	Curve Return Pulley
code	description	price	
EEETRA19	Curve Cord Guide	£46.00	
EEETRA20	Curve Master Runner	£110.00	
EEETRA21	Curve Head Pulley	£130.00	
EEETRA22	Curve Return Pulley	£62.00	
EEETRA23	Curve Suspension Bracket	£27.00	

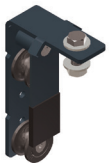
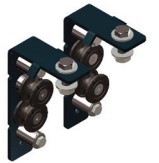
UniTrack Side Cord System

			
Side Cord Guide	Centre Overlap Divert	Side Cord Pulley Set	Side Cord Rope Clamp
code	description	price	
EEETRA32	Side Cord Guide	£60.00	
EEETRA33	Side Cord Centre Overlap Diverter	£120.00	
EEETRA34	Side Cord Head & Pulley set, 3 part	£115.00	
EEETRA35	Side-Cord Rope Clamp for Master Runner	£27.50	

Handlines

Choose the black polyester cord for all normal use, it makes for a very high quality and reliable handline. If you are using scenery carriers under heavy load on long tracks it can be advantageous to choose a rope with virtually no stretch. Flints stocks a Dyneema rope with a matt black polyester cover which is indistinguishable from the polyester rope except its working stretch is less than 1.5%. The Dyneema Pro is the best choice under very heavy loads because it does not have a polyester cover and the master carrier clamps directly to the line. The working stretch on this line is below 1.3% [Breaking load: 5,000 kg!].

code	description	breaking strain	per m
ROP122A	Black Polyester Cord [handline] 8mm	1000kg	£1.40
ROP438	Black Dyneema [polyester cover] 8mm	1500kg	£4.45
ROP150508	Dyneema Pro [pure Dyneema] 8mm	5300kg	£7.05
code	description	breaking strain	per 100 m full reel
ROP122AD	Black Polyester Cord [handline] 8mm	1000kg	£105.35
ROP438D	Black Dyneema [polyester cover] 8mm	1500kg	£323.60
ROP150508D	Dyneema Pro [pure Dyneema] 8mm	5300kg	£597.42

TDrive Motor

The Triple E TDrive is suitable for use with both their UniTrack and UniBeam systems. With variable speed controls to open/close and stop, it provides a clean solution. Supplied with a 10 m pendant.

Specifications: Pulls up to 300 kg on straight, 200 kg on curve. Hand Drives also available - call us for details and a quote.

code	description	price
EEETDRIVE	TDrive Motor	£2,650.00
TRAWC	Wireless Controller	£500.00

UniBeam Standard Track

UniBeam combines track and truss in one unit to provide a truly adaptable track system. Particularly appropriate for permanent installation, especially those that host a number of repertory productions, this modular system is suitable for anything from rock concerts to opera to theatre.

With its symmetrical I-beam shape and solid construction, UniBeam is a complete system which accepts an extensive range of accessories. Capable of large spans between two suspension points, UniBeam makes an extremely accommodating fly bar and also lends itself to large curved systems, particularly cycloramas. To motorise the system, use the TDrive listed above.

- ✓ Same profile as UniTrack so many of the accessories are interchangeable
- ✓ The continuous slot along the top and bottom will take standard Unistrut fittings
- ✓ The Uniring accessory locks to the channel with a quick 90° twist and allows drapes to be quickly attached to the underside of the beam
- ✓ Takes Heavy-Duty Scenery Carriers allowing Safe Working Loads of up to 385 kg
- ✓ Takes up to 1,070 kg of Uniformly Distributed Loads at 1 m centres

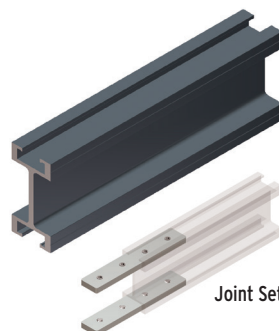

code	description	price
UBM01	Straight Track per 1 m [up to 6.1 m]	£80.00
UBM01C	Curved Track [min. radius 2 m]	£97.63
UBM05	Joint Set	£36.50
EEETRA24	Endstop	£12.00
EEETRA24S	Flat Endstop	£20.00

UniBeam Carriers and Pulleys

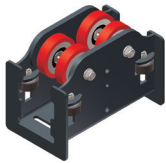
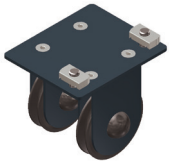
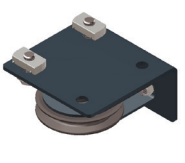
		
UniBeam Scenery Carrier Top Part	Head Pulley	Return Pulley
code	description	price
UBM28A	UniBeam Scenery Carrier top part [WLL 385 kg] Also takes UniTrack runners and accessories [see previous page]	£315.00
EEETRA09	Head Pulley	£82.50
EEETRA10	Return Pulley	£50.00
EEETRA0902	Head Pulley HD - Single Track	£87.00
EEETRA31R	Single Track Return Pulley	£29.19

UniBeam Mounting and Accessories

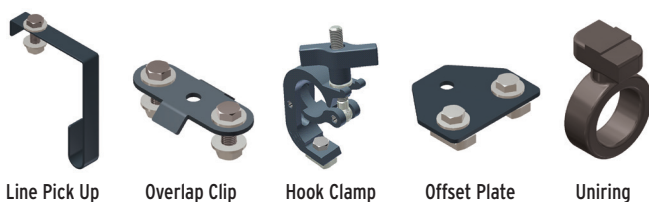

code	description	price
UBM14	Hook Clamp for 50 mm truss	£33.90
EEETRA17	Offset Plate	£8.00
UBM18	Studding Set [150 mm c/w nuts, channel nut and washers]	£6.00
EEETRA25	Line Pick Up	£10.00
EEETRA26	Overlap Clip	£15.00
URING	Uniring	£6.00

HARKEN TRACK

Ball Bearing Cars and Track

These super smooth freerunning cars and tracks are used in everything from sliding seats to window washing apparatus and from exercise machines to acrobatics. Loads move virtually free of any friction. The recirculating Delrin ball bearings are held captive so the cars can be easily removed from the tracks. The utility cars are derived from the toughest and best quality marine equipment but are simplified ready to accept your own customisation. The flat top surface is provided with two tapped M8 holes at 38 mm centres ready to accept your bolts or eye nuts. The track comes in either low-profile or a tough beam-section with built-in strength for spanning gaps.

- ✓ Use them for smooth-running stage machinery
- ✓ Perfect for sliding trap covers
- ✓ Friction-free scenery sliders
- ✓ Indoors or outside
- ✓ Maintenance-free – just flush with clean water!
- ✓ Tracks can be supplied rolled to compound curves – please phone our Rigging Manager for details

SPECIFICATION: Cars and bearing races machined from 6061-T6 Aluminium. Track extruded from high grade 6061-T6 aluminium. Black Hardcote anodising makes them extremely durable. If the tracks are ordered as set lengths [see below] both ends will be black anodised. The track can be easily cut but the cut end will not be anodised. Smaller and larger tracks are available – please phone our Rigging Manager for details.

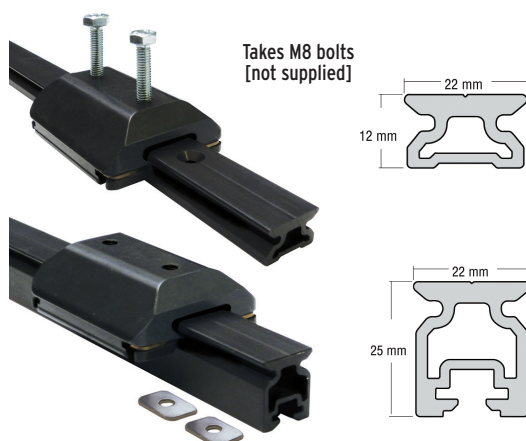

Takes M8 bolts
[not supplied]

SAFETY	Min Breaking Load	Safety Factor	SWL
	1,134kg	19.89 to 1	57kg

code	description	price
HAR272536	High Beam Track 3.6m	£237.85
HAR27201	Low Level Track 1m	£55.74
HAR27202	Low Level Track 1.8m	£89.50
HARHC8473	Utility Car M8 Threads	£109.71
HARE2200	Endstops [Low Level Track] Set of two	£13.30
HAR264	Endstops [High Beam Track] Set of two	£43.34

SPARES & ACCESSORIES

Track Spares

Flints has a wide experience of tab tracks based on forty-years of theatre work. We can normally recognise a component from a digital photo or sketch. Even very old components can often be supplied. If you have a troublesome track we can provide remote assistance, or if required we can visit your stage to either effect immediate repairs, or suggest a course of action. Below we have listed some of the common components and spares that we can supply.



Halls Common Components and Spares

code	description	price
HAL1701E	Twin Hooks [each]	£1.02
HAL3578	Tab Hook [per 10]	£10.96
HAL714	T70 Wheeled Runner [per 10]	£56.71
HAL713	T70 Ball Raced Runner [per 10]	£106.62
HAL71105	T70 Master Runner [per 2]	£33.56

Unirail Components and Spares

code	description	price
ROPGBC	Unirail Clip	£1.80

3-Way Track Components and Spares

code	description	price
EEE2W06P	Plain Wheel Runner	£4.00
EEE2W06C	Ball Raced Wheel Runner	£7.00

Handlines & Chains

code	description	price
WIR862	Mediumweight Jack Chain	£11.85
WIR861	Heavyweight Jack Chain	£19.95

Ropes

code	description	price
ROP042MD100	No. 4 Jute Sash [economical option for T60]	£36.52
ROP044MD100	No. 6 Jute Sash [economical option for T70]	£58.41

code	description	per m
ROP122A	Black Polyester Cord [handline] 8mm	£1.40
ROP438	Black Dyneema [polyester cover] 8mm	£4.45
ROP150508	Dyneema Pro [pure Dyneema] 8mm	£7.05

code	description	per 100 m full reel
ROP122AD	Black Polyester Cord [handline] 8mm	£105.35
ROP438D	Black Dyneema [polyester cover] 8mm	£323.60
ROP150508D	Dyneema Pro [pure Dyneema] 8mm	£597.42

TRACKS / TUBES & CLAMPS

TRACK LUBRICANTS

McLube™ Dry Lubricant

This easy to apply, fast drying lubricant instantly bonds to clean, dry surfaces, repelling dirt, and significantly reducing friction. High Performance Dry Lubricant lasts significantly longer than Teflon® additives, oil- or wax based lubricants and it is environmentally friendly, with no chlorofluorocarbons (CFCs), petroleum, or poison emitting toxins. Use on curtain tracks, sliding traps, sliding doors, cloths and anywhere friction is a problem.

- ✓ Can be used directly onto cloth with virtually no marking
- ✓ No sticky grease or dirty oil
- ✓ Solves many friction problems making your show more reliable, slicker and faster!



code	volume	price
HARML08	300ml	£19.73

Amberglide PTFE Spray

This PTFE lubricant is a multipurpose high quality lubricant enriched with PTFE for enhanced durability in high wear applications. It cleans, waterproofs and reduces friction. Particularly suitable for tab tracks. I have seen really troublesome tracks converted to smooth running ones with just one quick spray!



code	volume	price
SAF516	400ml	£23.38

TUBES & CLAMPS

TUBES & CLAMPS

Galvanised Steel Scaffold Tube

48.3 mm outside diameter tube is the industry standard for most applications, such as lighting positions, flying bars and staging leg supports. The 33.7 mm outside-diameter tube is used for applications where the larger tube would be inappropriate such as shelving, racking and handrail supports. Flints is happy to cut your tubes to length to speed up your fit-up. The full length price is for uncut full lengths. The half length prices include the cutting charge. All other lengths are charged at the per metre price plus the cutting charge. For large quantities of cut lengths please phone for a quotation.



Size 6	description	weight	length	wall THK	tube ø	price
SCF030FL	Full length	16kg	6m	3mm	33.7mm	£49.95
SCF030HL	Half length	8kg	3m	3mm	33.7mm	£26.39
SCF030	Per metre	2.5kg		3mm	33.7mm	£8.79
Size 8	description	weight	length	wall THK	tube ø	price
SCF090FL	Full length	29.82kg	6m	4mm	48.3mm	£49.95
SCF090HL	Half length	14.91kg	3m	4mm	48.3mm	£27.00
SCF090	Per metre	4.66kg		4mm	48.3mm	£9.95
CUTS	Cutting charge [per cut]					£0.80

Aluminium Scaffold Tube

48.3 mm outside diameter. Aluminium tube is about one third of the weight of galvanised tube. Flints is happy to cut your tubes to length to speed up your fit-up. Cut lengths can sometimes speed up delivery, too. The full length price is for uncut full lengths. The half length prices include the cutting charge. All other lengths are charged at the per metre price plus the cutting charge. For large quantities of cut lengths please phone for a quotation.

Conformity: BS 1139. Aluminium grade: 6082. Tensile Strength: 316 N/mm2



Size 8	description	weight	length	wall THK	tube ø	price
SCF091FL	Full length	10.07kg	6m	4.47mm	48.3mm	£61.95
SCF091HL	Half length	5.04kg	3m	4.47mm	48.3mm	£35.65
SCF091	Per metre	1.65kg		4.47mm	48.3mm	£13.70
CUTS	Cutting charge [per cut]					£0.80

Black Anodised Aluminium Scaffold Tube

This tube is the ideal choice for unobtrusive rigging positions and flying bars. The semi-matt black finish will not catch the light like self-colour aluminium tube. Aluminium is notoriously difficult to paint so for a long-lasting high quality finish black anodising is the preferred method. The tube is supplied wrapped to protect it during storage. There are occasionally some small witness marks which are part of the anodising process. When ordering cut lengths, we advise there is likely to be some damage to the finish, so we would recommend purchasing a can of matt black spray [page 75] to touch up. The tube is extruded in accordance with BS EN755. Aluminium grade: 6082T6. The anodising is carried out in accordance with EN BS ISO 7599:2010.

Please contact us for information on full length delivery availability.



Size 8	description	weight	length	wall THK	tube ø	price
SCF091BFL	Full length	10.07kg	6m	4.47mm	48.3mm	£115.00
SCF091BHL	Half length	5.04kg	3m	4.47mm	48.3mm	£72.50
SCF091B	Per metre	1.65kg		4.47mm	48.3mm	£26.50
CUTS	Cutting charge [per cut]					£0.80